



WEALDEN HOUSE, E3

OIEO £350,000 L/H

- Two Bedroom / Two Bathroom
- Well Tended Shared Gardens
- Excellent Transport Links
- 999 Year Lease
- Chain Free
- Modern Private Development

wj.
meade

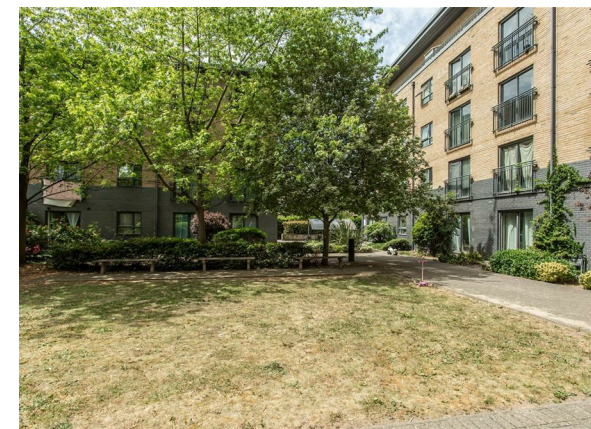
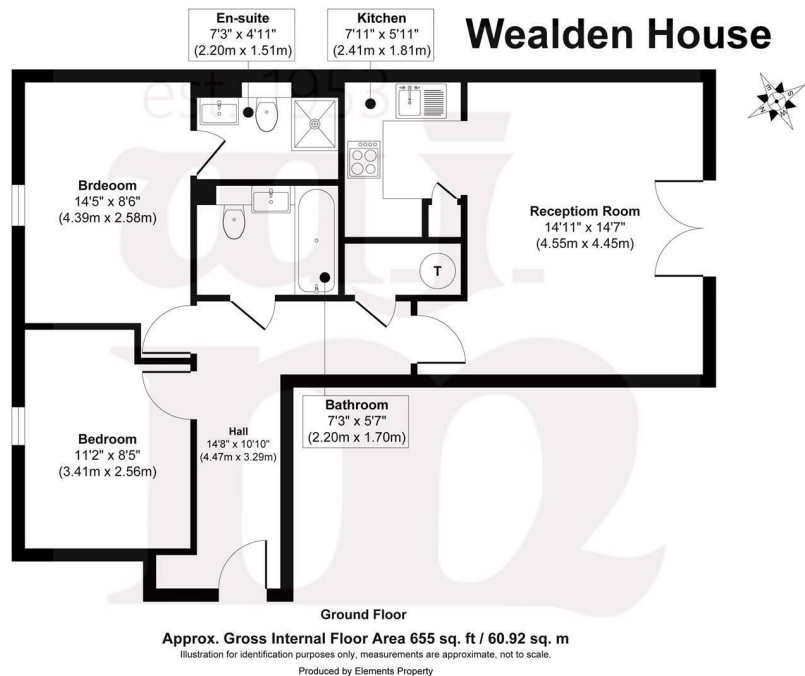

WJ Meade are pleased to present this two double bedroom apartment set on the ground floor of a small, gated residential development just moments from Bromley By Bow underground Station. Arranged over 655 sq ft with an open plan fitted kitchen to reception room with French doors leading out onto a landscaped communal garden. Having recently undergone a fresh redecoration the property is ideal as a first home or ready made rental investment.

All sizes are approximate. The Agent has not tested any apparatus, equipment, fixtures and fittings, or services and so cannot verify that they are in working order or fit for the purpose. A buyer is advised to obtain verification from their Solicitors or Surveyor. Photographs are for illustration purposes only and may depict items, which are not for sale or included in the sale price. References to tenure of a property are based upon information supplied by the vendor. The agent has not had sight of the title documents, a buyer is advised to obtain verification from their solicitor. Money Laundering Regulations 2003: Intending purchasers will be asked to produce identification, documentation at a later stage and we would ask for your co-operation in order that there will be no delay in agreeing the sale.

These particulars are intended to give a fair description of the property only and are in no way guaranteed, nor do of any contract. They are issued on the express condition that all negotiations are conducted through W.J. Meade Estate Agents. All subject to contract and to being unsold.

Service charge £2,244.15 pa
 Ground rent £350 pa
 975 years lease
 Council tax band D
 Current EPC Rating 55
 Tenure: Leasehold

